

modric

Simplicity in form, made without compromise. A fully coordinated collection of ironmongery and hardware setting the industry standard since 1965.

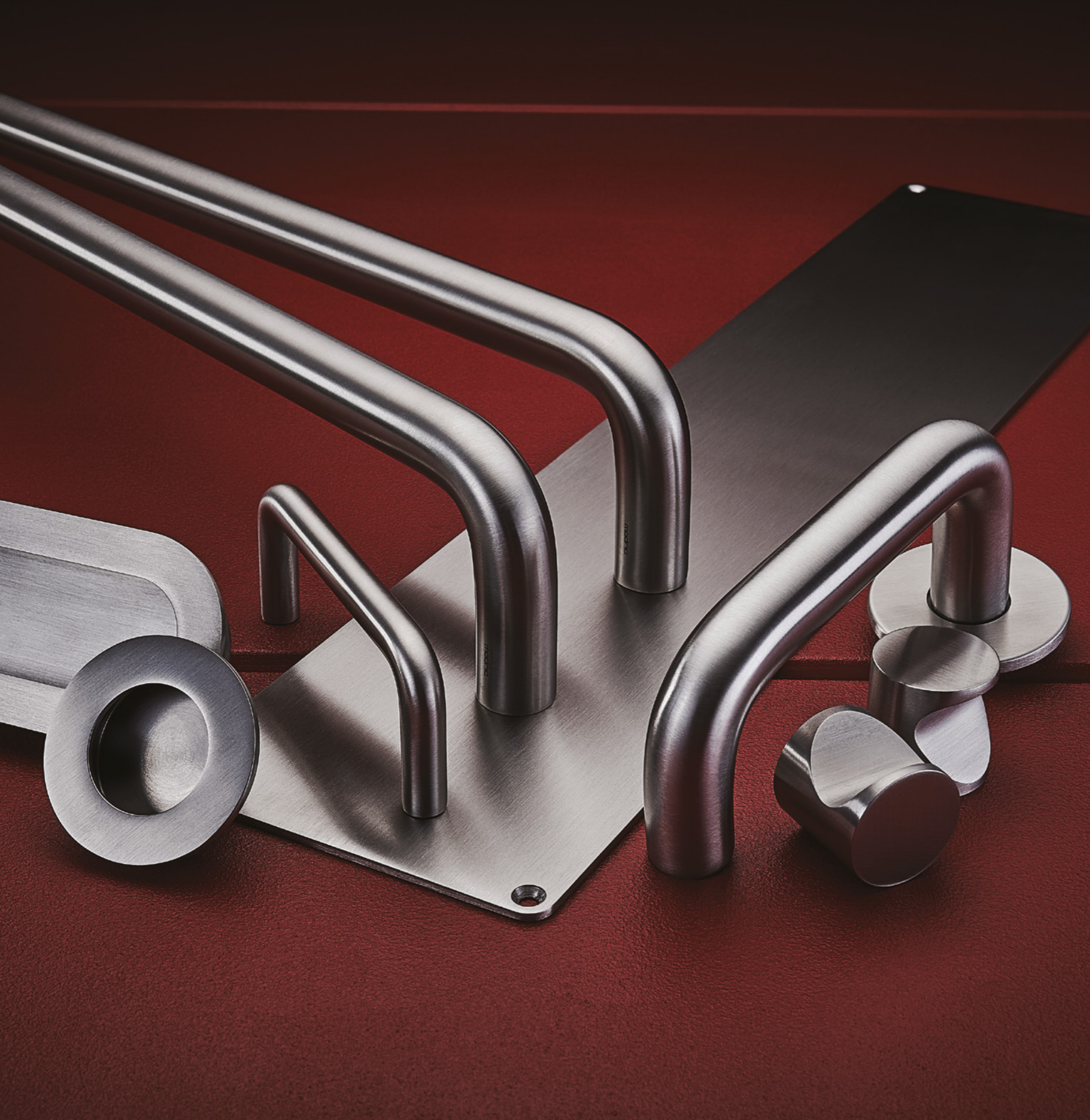



modric 

Made without compromise.

Modric™ embodies a design philosophy. Inspired by Bauhaus principles, the elegant simplicity of each product expresses its purpose with high-quality materials precisely engineered in beautiful detail to last a lifetime. Function without ornament.

Launched in 1965, Modric was the first coordinated range of architectural ironmongery and hardware with a uniform aesthetic. Designed by Alan Tye and Knud Holscher, it set new standards for door hardware with its uncompromising commitment to design consistency and engineering excellence and is integral to the history of Allgood.

The first Modric range comprised 150 pieces created to be specified together. A modular collection that launched just as the UK adopted the metric system – hence the name (**Mod**ular + **Met**ric) – elements were interchangeable and identically finished. Modric won numerous national and international design awards at launch and has been recognised by the world's leading art and design museum, the Victoria & Albert in London, with a permanent collection.

Purity and simplicity define Modric's understated appeal. The clean lines and simple ergonomic forms, designed and made with an absolute attention to detail, sit quietly and harmoniously in any building. For over 50 years, Modric has been installed in projects across all sectors and remains our most popular range – a testament to its enduring aesthetic and engineering.

Today, Modric has evolved in design and construction. But it has never deviated from the original design philosophy: conceived for simplicity and made without compromise.

The history of Modric

The origins of Modric trace back to the early 1960s. At the time, Knud Holscher M.A.A. and Alan Tye A.R.I.B.A. worked for the renowned Danish architect Arne Jacobsen on the designs for St Catherine's College in Oxford. The college – now Grade 1 listed – is regarded as a modernist masterpiece, lauded for its restrained and simple design with an unrelenting focus on detail.

The experience was instrumental for Holscher & Tye in their formulation of what became Modric. With a set of early prototypes made from aluminium, they sought a partner to produce the range. They presented the concepts to G&S Allgood Limited, who decided to sponsor them and arranged manufacture. Within nine months the new range of 150 products was on display at the 1965 International Building Exhibition.

Modric was an instant success and won several design awards at launch, including the 1966 Council of Industrial Design and Design Centre Awards.



HRH Duke of Edinburgh visiting the Modric display at the 1967 International Building Exhibition



A page from the 1965 Modric launch brochure

Allgood founders Paul Shirville - second left - and Derrick Carter-Clout - far right - with the 1966 British Aluminium Society – Best New Aluminium Product Award



“

We believed in the theory right from the start when we gave designers Holscher & Tye a free hand to fill the long-felt want for a truly comprehensive and compatible range of architectural ironmongery

1965 Paul Shirville, Joint Managing Director, Allgood

The Modric launch display at the 1967 International Building Exhibition



“

Modric has many advantages. Because the comprehensive range is coordinated and maintains a high design standard throughout, an architect can simply specify its use throughout a building and close attention has been paid to detail...

1966 Judges comments in Design Magazine

The history of Modric continued

Modric modernised previously traditional ironmongery, by creating clean and functional forms which resonated with post-war design ideals.

At launch, Modric was made entirely from aluminium with an angular geometric aesthetic. During the 1970s, stainless steel options were introduced to add greater durability and the uniform fine grain finish. Market demands for more rounded ergonomic forms influenced the evolving designs, as well as dimensional choices such as the 19mm diameter bar used on all levers and pull handles to achieve the perfect grip. With the advent of building standards, the first return-to-door levers were added to meet accessibility and safety requirements.

For over 50 years, Modric has been installed on landmark projects, such as the QE2 (1960s), The World Trade Centre Dubai (1970s), The Royal Train (1970s), Hong Kong Airport (1990s), Canary Wharf (1990s), the New Design Museum (2000s), The Shard (2010s), Tate Britain (2010s) and the Dyson Building of Design Engineering at Imperial College London (2010s).

Today Modric remains true to Holscher & Tye's original principles. Timeless, elegant, and designed to meet the demands of modern use, beautifully.

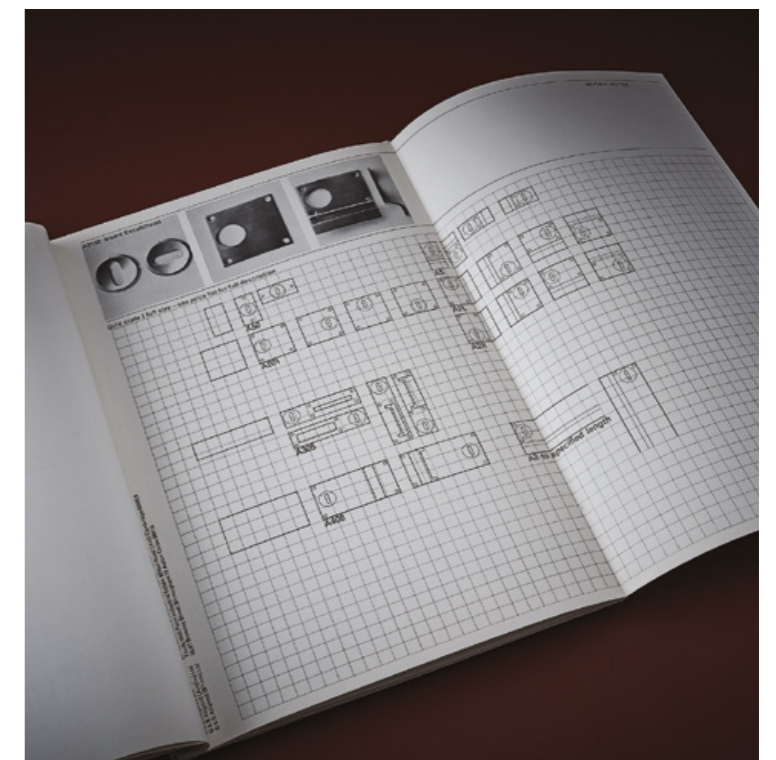

A fully coordinated range - your guarantee of quality

The first fully coordinated range, Modric hugely simplified the process of specification with its 150 complementary products. Previously, architects had to source individual pieces of ironmongery with little or no guarantee of a consistent design and appearance.

A uniform aesthetic and robust construction define the Modric range, providing a coherence every bit as relevant today as in 1965. Making the specification of door sets simple, each handle, sign, kick plate and door closer is crafted from premium materials and hand polished to achieve a universal fine line grain direction.

Every Modric product is made from the best materials – such as solid grade 316 stainless steel – at our dedicated manufacturing plant in Birmingham, UK, by workers with decades of experience. This accumulated knowledge assures quality control which is essential for maintaining the standards which define the range. All levers are mounted on Allgood's patented Quadaxial™ rose which has been tested to over a million cycles, far exceeding any industry performance standard.

Decades after installation Modric products will still be found in near-perfect mechanical condition because of the high quality of materials used and the engineered precision of our manufacturing processes. This commitment to product quality with a design that transcends fashion, minimises waste by significantly extending lifecycles and virtually eliminating repair – thereby reducing the excessive use of the planet's resources.

Fully certified in Allgood's name for international and UK markets, Modric is a coordinated range for complex times, since 1965.

“

With standard door furniture, the architect is limited to those patterns available and has very little freedom in method or position of fixing, other than designing a 'special'.

Modric, with its never-ending simple variations, gives the architect the opportunity of expressing themselves by using standard components in a variety of ways... with items both aesthetically and ergonomically related to each other.

1965 Modric launch brochure





The push plate - an exercise in symmetry



The bend - premium materials, precision engineering and decades of expertise

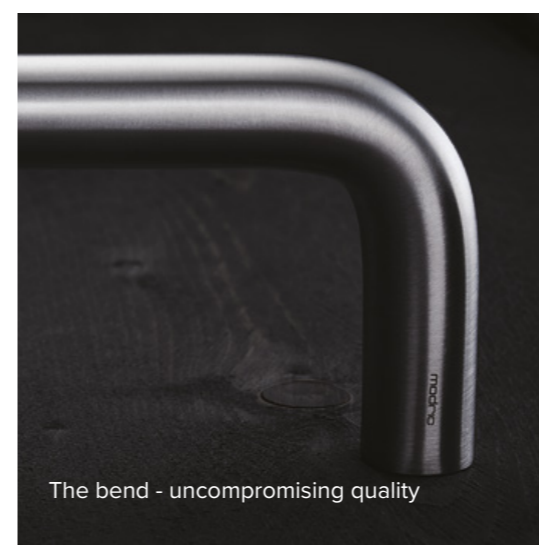
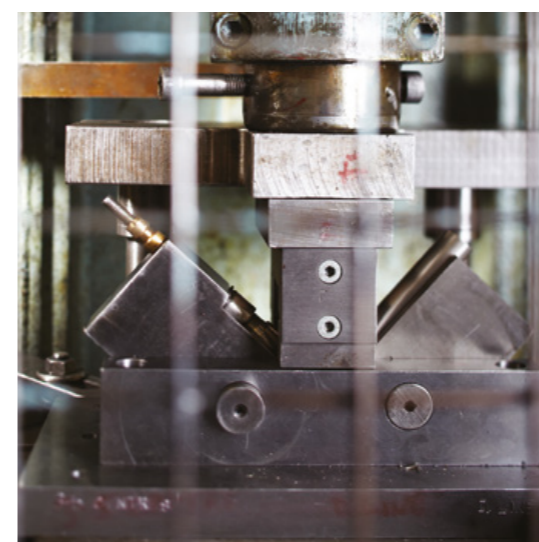

The bend - uncompromising quality



The finish - only the most experienced polishers can achieve the Modric standard

Beauty in every detail

Modric is a mindset. Over the decades, it has become part of our language at Allgood where it is a byword for high standards in design and engineering – excellence without compromise, and without pomp. If something does not meet this standard, we say “that’s not Modric”. This could be the position of a screw hole, the radius of a bend, or the quality of the finish. Details matter.

The push plate

An exercise in symmetry. The corners of the Modric push plate have a radius of 6mm. The screw hole is 6mm from the edge and sits quietly and neatly in the centre of the radius arc. The screw hole itself has been precision engineered – each hole countersunk and then counterbored so that the entire screw – including the flat top of the head – is flush to the plate itself.

The bend

A harmony of material and process. The understated elegance of the Modric ‘bent bar’ has many imitators, but none, in our humble opinion, shares the combination of premium materials and engineering precision. Starting with a 19mm solid grade 316 solid stainless-steel bar, our bespoke tooling, and decades of manufacturing experience create a balanced and clean bend, the radius of which perfectly matches the radius of the bar. Obsession? Perhaps – but we believe the quiet harmony in design details like that enhances the experience of the object in use.

The finish

A standard without equal. The characteristic fine finish of the entire range requires a process so exacting that only a handful of the most experienced polishers can attain the grade. What begins with routine grit band polishing, continues with finer and finer grades of grit then several ‘mop’ polishes by hand to create a perfect satin finish with the fine lines in the grain of the steel always in a universal direction. On every element, in every bend, every time.

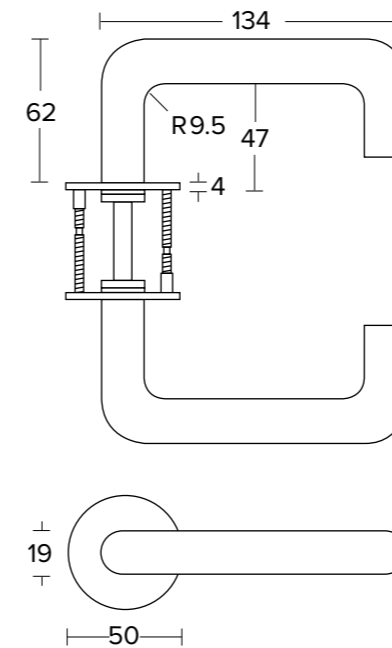

3510 Modric Lever Handle

Description

- Independently tested to BS EN 1906
- Supplied with Quadaxial concealed fixing roses (tested to 1 million cycles)
- Supplied with 8mm spindle and bolt through fixings to suit 35-54mm thick doors
Longer spindle and fixings are available for thicker doors on request
- Incorporated in successful fire tests and assessed to BS EN 1634-1 and BS 476 Pt 22 up to 60 minutes on timber doors and 120 minutes on metal doors
- Adheres to the dimensional guidelines of BS 8300 and Approved Doc M
- Hand finished
- Grade 316 solid stainless steel
- 25 year mechanical warranty

Available Finishes

SS · PS · BF



3509 Modric Lever Handle

Description

- Independently tested to BS EN 1906
- Supplied with Quadaxial concealed fixing roses (tested to 1 million cycles)
- Supplied with 8mm spindle and bolt through fixings to suit 35-54mm thick doors *Longer spindle and fixings are available for thicker doors on request*
- Incorporated in successful fire tests and assessed to BS EN 1634-1 and BS 476 Pt 22 up to 60 minutes on timber doors and 120 minutes on metal doors
- Hand finished
- Grade 316 solid stainless steel
- 25 year mechanical warranty

Available Finishes

SS · PS · BF

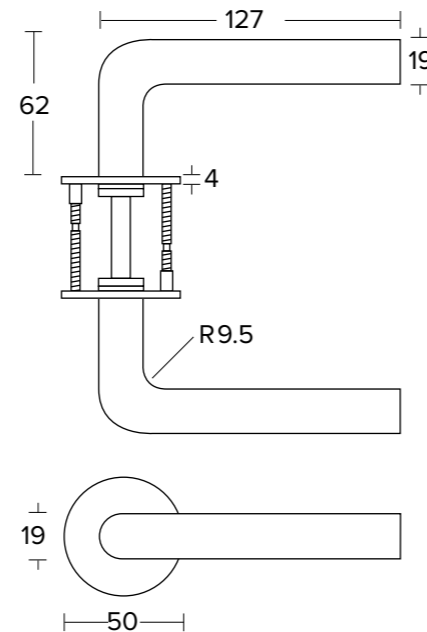

3508 Modric Lever Handle

Description

- Independently tested to BS EN 1906
- Supplied with Quadaxial concealed fixing roses (tested to 1 million cycles)
- Supplied with 8mm spindle and bolt through fixings to suit 35-54mm thick doors *Longer spindle and fixings are available for thicker doors on request*
- Incorporated in successful fire tests and assessed to BS EN 1634-1 and BS 476 Pt 22 up to 60 minutes on timber doors and 120 minutes on metal doors
- Hand finished
- Grade 316 solid stainless steel
- 25 year mechanical warranty

Available Finishes

SS · PS · BF

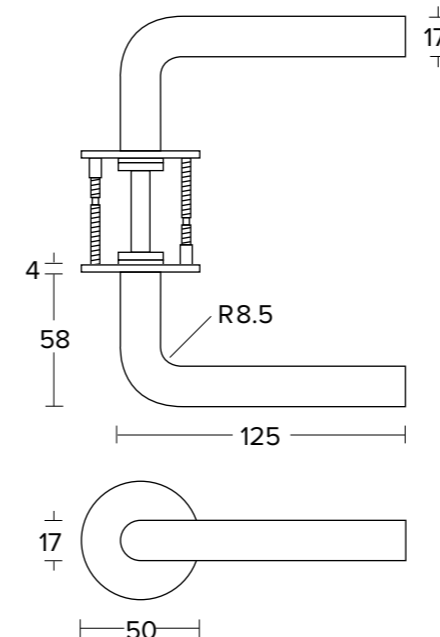

Modric Ø19mm 'D' Pull Handles

Description

- Incorporated in successful fire tests and assessed to BS EN 1634-1 and BS 476 Pt 22 up to 120 minutes on timber doors and 120 minutes on metal fire doors
- Adheres to the dimensional guidelines of BS 8300 and Approved Doc M
- Hand finished
- Grade 316 solid stainless steel
- 25 year warranty
- Fixings supplied for doors up to 55mm
 - Bolt Through fixings order code 6598 / 6599 / 6600 / 6601
 - Concealed Face fixings order code 6598SFF / 6599SFF / 6600SFF / 6601SFF
- Back to Back pair includes fittings suitable for Glass Doors order code 6598BB / 6599BB / 6600BB / 6601BB

Standard Sizes (mm)

Item code	O/A Length mm (A)	Centres mm (B)
6598	419	400
6599	669	650
6600	919	900
6601	1219	1200

Bespoke lengths available

Available Finishes

SS · PS · BF

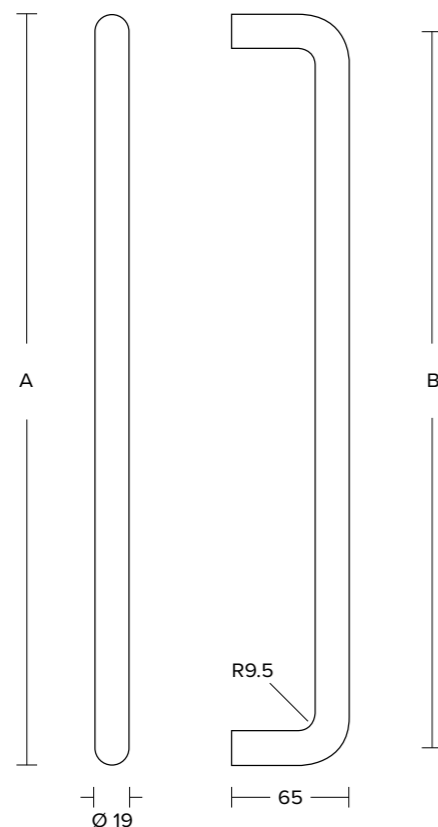

Modric Ø19mm Cranked Pull Handles

Description

- Incorporated in successful fire tests and assessed to BS EN 1634-1 and BS 476 Pt 22 up to 60 minutes on timber doors and 120 minutes on metal fire doors
- Adheres to the dimensional guidelines of BS 8300 and Approved Doc M
- Grade 316 solid stainless steel
- Hand finished
- 25 year warranty
- Fixings supplied for doors up to 55mm
 - Bolt Through fixings order codes 6598C / 6599C
 - Back to Back pair includes fittings suitable for Glass Doors order codes 6598CBB / 6599CBB

Standard Sizes (mm)

Item code	O/A Length mm (A)	Centres mm (B)
6598C	419	400
6599C	669	650

Bespoke lengths available

Available Finishes

SS · PS · BF

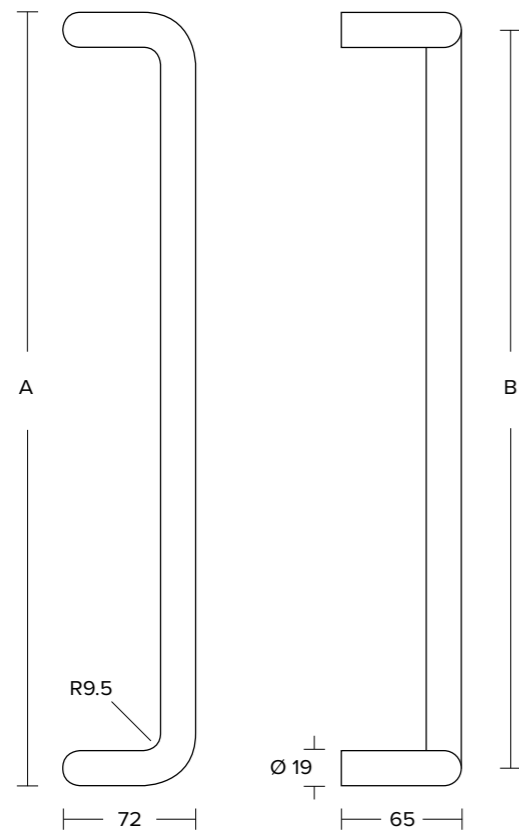



2505 Modric Operating Knob Handles

Description

- 42mm x Ø47mm
- Supplied with Ø47mm roses x 2.5mm thickness
- Supplied with 8mm spindle and fixings to suit doors 32-55mm thickness
- Incorporated in successful fire tests and assessed to BS EN 1634-1 and BS 476 Pt 22 up to 60 minutes on timber doors and 120 minutes on metal fire doors
- Hand finished
- Grade 316 Solid Stainless steel
- 25 year warranty

Available Finishes

SS · PS · BF

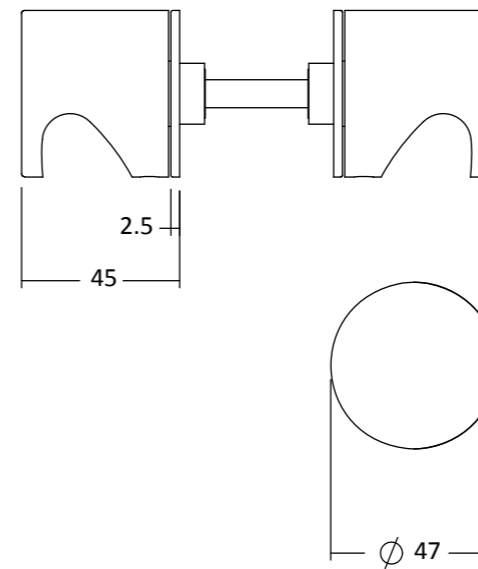

2511 Modric Fixed (Non-Operating) Knob Pull Handles

Description

- 42mm x Ø47mm
- Supplied with through fixings to suit doors 10-55mm thickness
- Incorporated in successful fire tests and assessed to BS EN 1634-1 and BS 476 Pt 22 up to 60 minutes on timber doors and 120 minutes on metal fire doors
- Order code 750 roses not required with this product
- Suitable for use in pairs on timber and glass doors
- Suitable for use singly on timber doors
- Grade 316 Solid Stainless steel
- Hand finished
- 25 year warranty

Available Finishes

SS · PS · BF

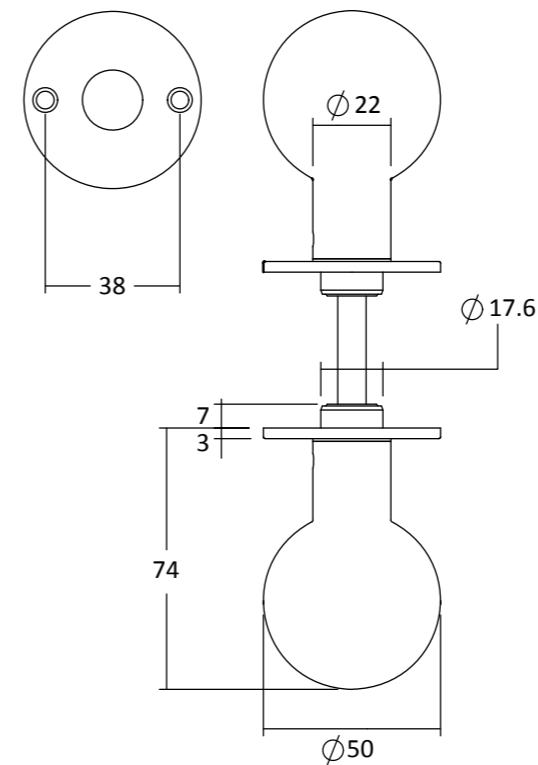
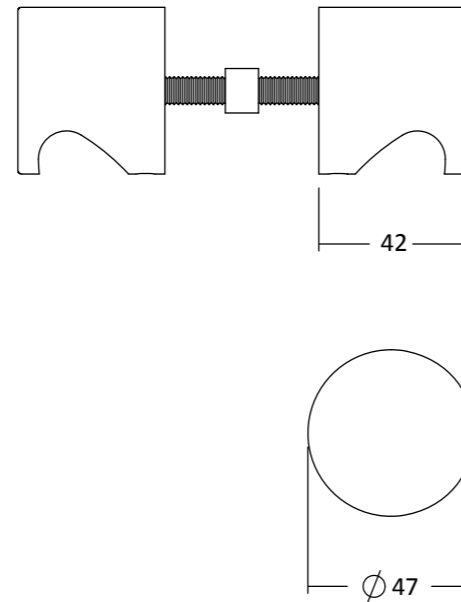

2512 Modric Mortice Ball Operating Knob Set

Description

- 74mm x Ø50mm
- Supplied as a pair of Knobs on face fixing roses
- Supplied with 8mm spindle to suit doors 35-54mm
- Grade 316 stainless steel
- Hand finished
- 25 year warranty

Available Finishes

SS · PS · BF



Modric Radius Push Plates

Description

- Supplied with visible Torx screw fixings
- 2.5mm thickness
- Radius Corners
- Incorporated in successful fire tests and assessed to BS EN 1634-1 and BS 476 Pt 22 up to 120 minutes on timber doors and 240 minutes on metal doors (**6802G & 6802K only**)
- Hand finished
- Grade 316 stainless steel
- 25 year warranty

Available Finishes

SS · PS · BF

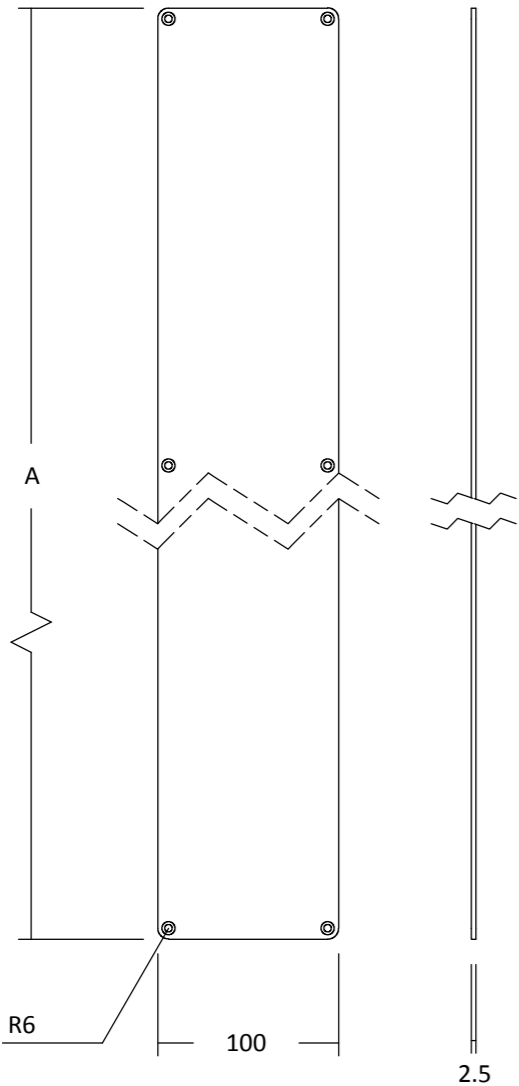

Standard Sizes (mm)

Item code	O/A Height mm (A)
6802G	450
6802K	700
6802M	1000

Bespoke lengths available



6215 Modric Flush Pull Handle

Description

- Supplied with concealed screw fixings
- Suitable for use on sliding doors & hinged doors
- Incorporated in successful fire tests and assessed to BS EN 1634-1 and BS 476 Pt 22 up to 60 minutes on timber doors
- Hand finished
- Grade 316 stainless steel
- 25 year warranty

Available Finishes

SS · PS · BF

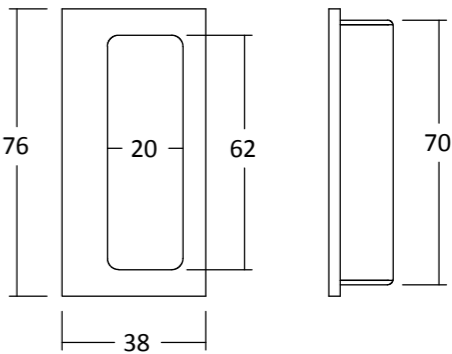
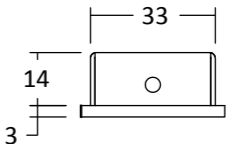



6260 Modric Flush Pull Handle

Description

- Suitable for use on sliding & hinged doors
- Supplied with screws for concealed face fixing
- Incorporated in successful fire tests and assessed to BS EN 1634-1 and BS 476 Pt 22 up to 60 minutes on timber doors
- XX6250FP intumescent pack (specified & supplied separately) must be used when installing this product in a BS EN 1634 compliant fire door
- Hand finished
- Grade 316 stainless steel
- 25 year warranty

Available Finishes

SS · PS · BF

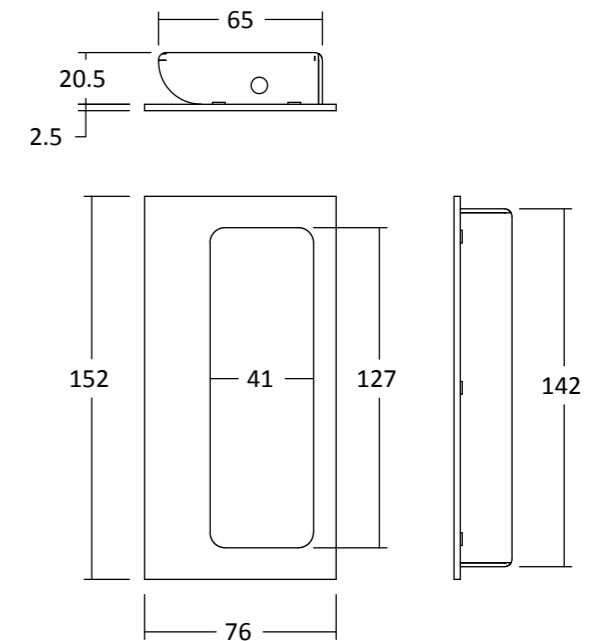

6250 Modric Flush Pull Handles

Description

- XX6250FP intumescent pack (specified & supplied separately) must be used when installing this product in a BS EN 1634 compliant fire door
- Suitable for use on doors 33-54mm thick
- Supplied with both bolt through and back-to-back fixings*
- Incorporated in successful fire tests and assessed to BS EN 1634-1 and BS 476 Pt 22 up to 60 minutes on timber doors *
- Can be used as 2 single pulls on double leaf doors
- Suitable for use on sliding & hinged doors
- Hand finished
- Grade 316 stainless steel
- 25 year warranty

Available Finishes

SS · PS · BF

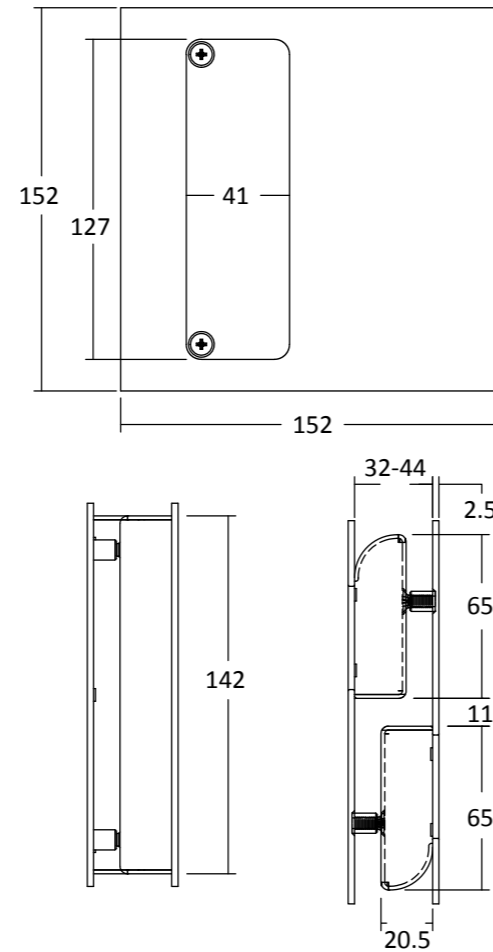

Standard Sizes (mm)

Item code	O/A Length mm (A)
6220	110
6221	170

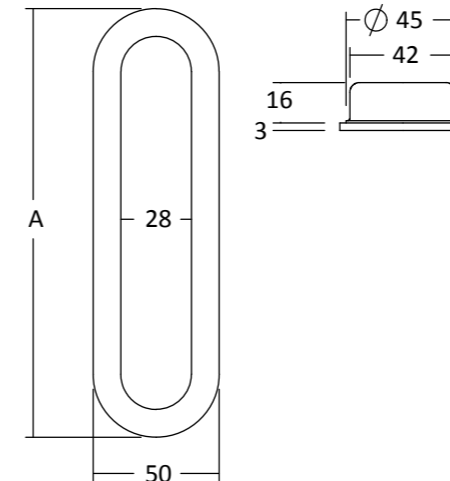

Modric Oval Flush Pull Handles

Description

- Supplied with concealed screw fixings
- Suitable for hinged and sliding doors*
- Hand finished
- Grade 316 stainless steel
- 25 year warranty

Available Finishes

SS · PS · BF

* Small size suitable for sliding doors only





Modric Round Flush Pull Handles

Standard Sizes (mm)

Item code	Diameter mm (A)	Diameter mm (B)	Depth mm (C)
6210	Ø50	Ø40	11
6211	Ø80	Ø62	14

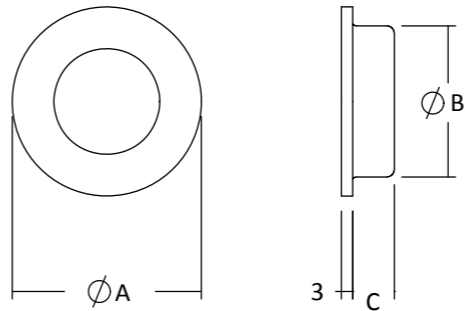

Description

- Suitable for pin and adhesive fixing
- Only for use on sliding doors
- Incorporated in successful fire tests and assessed to BS EN 1634-1 and BS 476 Pt 22 up to 60 minutes on timber doors
- Hand finished
- Grade 316 stainless steel
- 25 year warranty

Available Finishes

SS · PS · BF



Modric Ø10mm Cabinet Pull Handles

Description

- Projection 40mm as Standard
- Supplied with M5x50 bolt through fixings
- Suitable for use on doors up to 45mm thick
- Hand finished
- Grade 316 solid stainless steel
- 25 year warranty

Available Finishes

SS · PS · BF

Standard Sizes (mm)

Item code	O/A Length mm (A)	Centres mm (B)
2540	106	96
2541	138	128
2542	234	224
2543	330	320
2544	426	416
2545	522	512

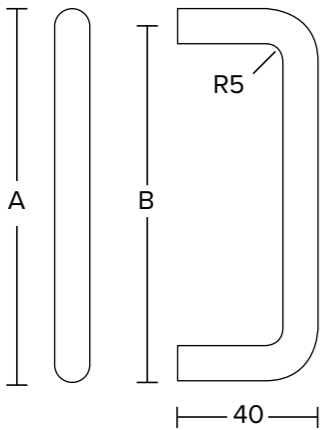

Modric Ledge Pull Handles

Description

- Aluminium extrusion simulated satin or polished finish
- Supplied with visible face fixings
- Suitable for use on sliding doors or drawers
- Hand finished
- 25 year warranty

Available Finishes

S · Simulated satin stainless steel
P · Simulated polished stainless steel

Standard Sizes (mm)

Item code	O/A Length mm (A)	Projection mm (B)
1714/1	100	45
1714/2	200	45
1716/1	100	70
1716/2	200	70

Other lengths available up to 2000mm

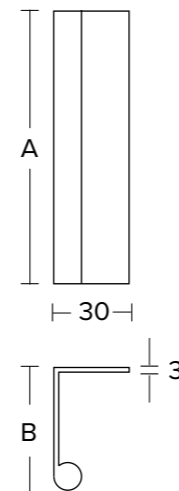

Modric Cabinet Knob Handles

Description

- Supplied with M4 x 40mm bolt through fixings
- Secret face fixings (dowel screw) also available
- Suitable for doors up to 30mm thick
- Grade 316 solid stainless steel
- Hand finished
- 25 year warranty

Available Finishes

SS · PS · BF

Standard Sizes (mm)

Item code	O/A Length mm (A)	Diameter (B)
2516	29	Ø29
2520	23	Ø19

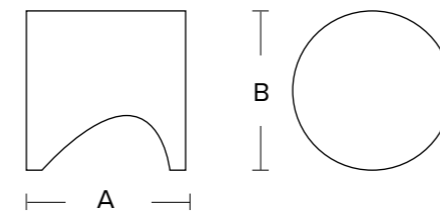

796Q Modric Euro Profile Cylinder Escutcheon

Description

- Ø50mm x 4mm
- Supplied with concealed face fixings
- Incorporated in successful fire tests and assessed to BS EN 1634-1 and BS 476 Pt 22 for use up to 60 minute timber fire doors
- Hand finished
- Grade 316 stainless steel
- 25 year warranty

Available Finishes

SS · PS · BF

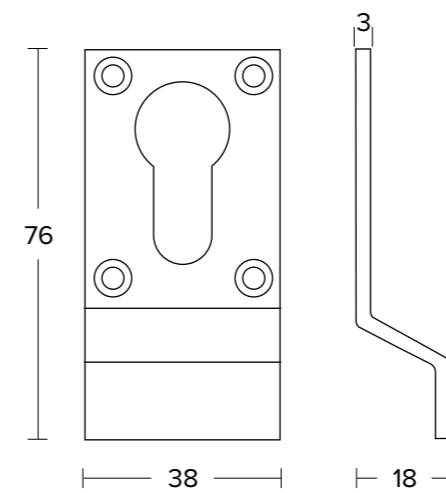
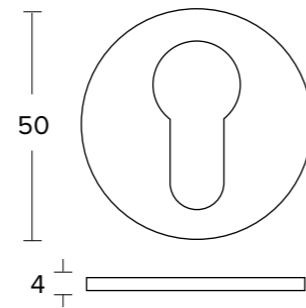

8 Modric Euro Profile Cylinder Pull

Description

- Size 76x38x3mm
- Suitable for Euro Profile Cylinder
- Supplied with visible Torx screw fixings
- Grade 316 solid stainless steel
- Hand finished
- 25 year warranty

Available Finishes

SS · PS · BF

13010 Modric WC Turn and Emergency Release Indicator Set

Description

- Inside Turn and External emergency coin release with indicator
- Supplied with concealed fixings to suit doors up to 55mm thick
- Incorporated in successful fire tests and assessed to BS EN 1634-1 and BS 476 Pt 22 up to 60 minutes on timber doors
- Suitable for 5mm and 8mm lock followers
- Hand finished
- Grade 316 stainless steel
- 25 year mechanical warranty

Available Finishes

SS · PS · BF

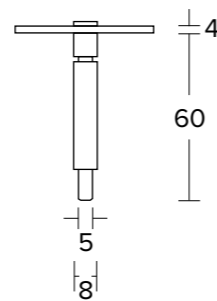
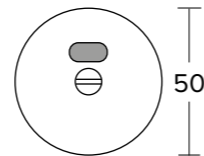
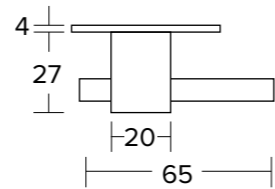
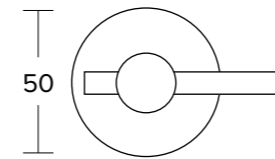

771Q2529 Modric WC Turn and Emergency Release Indicator Set

Description

- Ø50mm x 4mm
- Concealed fixings to suit doors 32mm to 55mm thickness
- Incorporated in successful fire tests and assessed to BS EN 1634-1 and BS 476 Pt 22 for use up to 60 minute timber fire doors
- Suitable for 5mm and 8mm lock followers
- Grade 316 stainless steel
- Hand finished
- 25 year mechanical warranty

Also Available

771Q2529NI Modric WC Turn and Emergency Release Set without Indicator

Available Finishes

SS · PS · BF

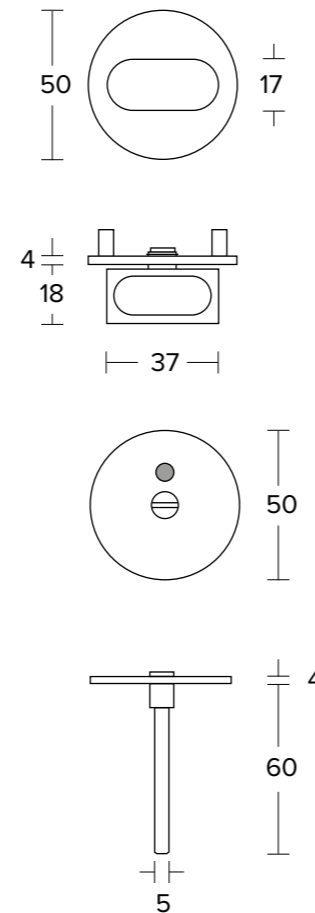

771Q2530 Modric Disabled WC Turn and Emergency Release Indicator Set

Description

- Ø50mm x 4mm
- Concealed fixings to suit doors 32mm to 55mm thickness
- Incorporated in successful fire tests and assessed to BS EN 1634-1 and BS 476 Pt 22 for use up to 60 minute timber fire doors
- Suitable for 5mm and 8mm lock followers
- Grade 316 stainless steel
- Hand finished
- 25 year mechanical warranty

Also Available

771Q2530NI Modric Disabled WC Turn and Emergency Release Set without Indicator

Available Finishes

SS · PS · BF

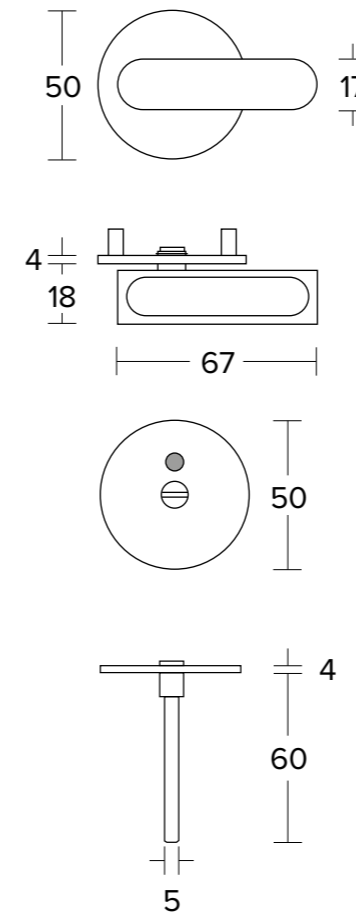

779Q Modric Emergency Release with External Indicator Rose

Description

- Ø50mm x 4mm
- Emergency release only
- Hand finished
- Concealed face fixings
- Can be used with concealed bolt through fixings
- Suitable for use with various Modric, Holt or Sembla thumbturns
- Incorporated in successful fire tests and assessed to BS EN 1634-1 and BS 476 Pt 22 for use up to 60 minute timber fire doors
- Suitable for 5mm and 8mm lock followers
- Grade 316 stainless steel
- 25 year mechanical warranty

Available Finishes

SS · PS · BF

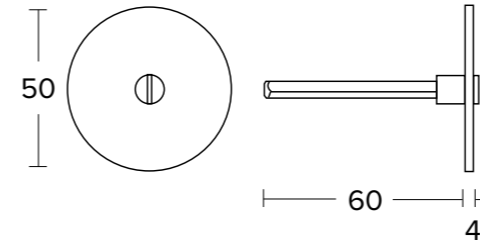
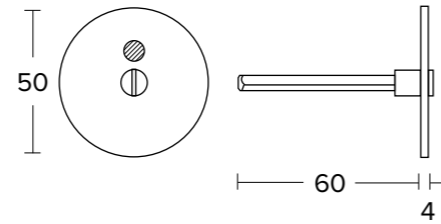

786Q Modric Emergency Release Rose

Description

- Ø50mm x 4mm
- Concealed face fixings
- 50mm diameter to match Modric knob handles
- Incorporated in successful fire tests and assessed to BS EN 1634-1 and BS 476 Pt 22 for use up to 60 minute timber fire doors
- Suitable for 5mm and 8mm lock followers
- Grade 316 stainless steel
- Hand finished
- 25 year mechanical warranty

Available Finishes

SS · PS · BF

Modric Floor Mounted Door Stops

Description

- Supplied with concealed fixings
- Suitable for use on timber and masonry floors
- Hand finished
- Grade 316 solid stainless steel
- 25 year warranty

Available Finishes

SS · PS · BF

Standard Sizes (mm)

Item code	O/A Height mm (A)	Diameter mm (B)	Base Diameter mm (C)
2301	38	Ø47	Ø35
2302	32	Ø32	Ø22

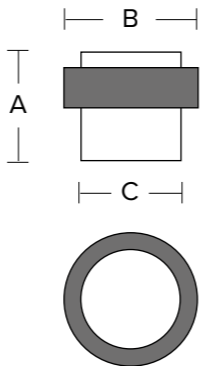

Modric Wall/Skirting Mounted Buffered Door Stops

Description

- Supplied with concealed fixings
- Hand finished
- Grade 316 solid stainless steel
- 25 year warranty

Available Finishes

SS · PS · BF

Standard Sizes (mm)

item code	Projection mm (A)	Diameter mm (B)
2305	63	Ø19
2307	102	Ø25

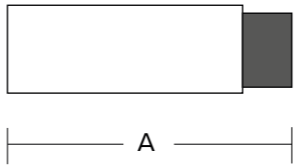

2315 Modric Skirting Buffer

Description

- Projection 75mm x Ø14mm
- Supplied with concealed fixings
- Supplied with support rose Ø30mm x 2mm
- Hand finished
- Grade 316 stainless steel
- 25 year warranty

Available Finishes

SS · PS · BF

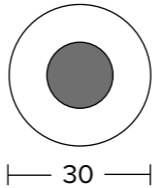
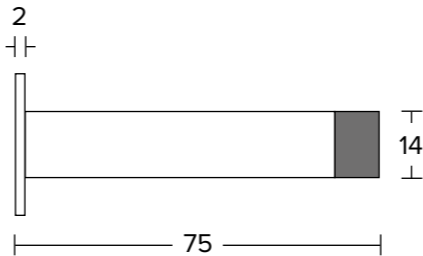



6542 Modric Buffered Coat Hook

Description

- Projection 75mm x Ø14mm
- Supplied with concealed face fixings
- Supplied with support rose Ø30mm x 2mm
- Grade 316 solid stainless steel
- Hand finished
- 25 year warranty

Available Finishes

SS · PS · BF

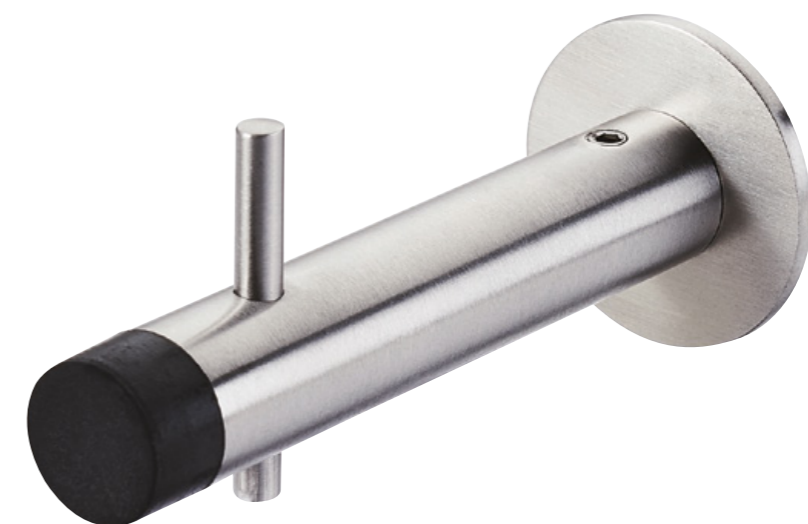
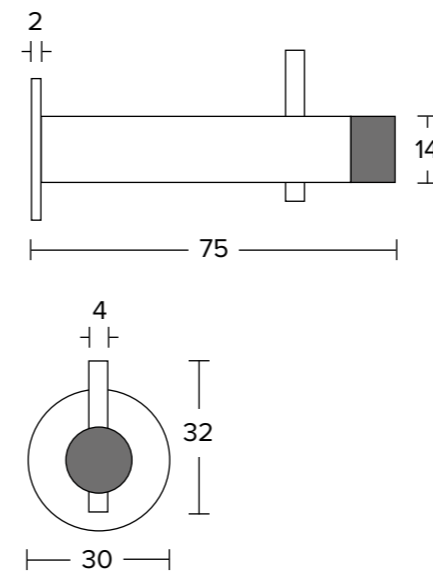

6541 Modric Coat Hook

Description

- Projection 38mm x Ø14mm
- Supplied with concealed face fixings
- Supplied with support rose Ø30mm x 2mm
- Grade 316 solid stainless steel
- Hand finished
- 25 year warranty

Available Finishes

SS · PS · BF

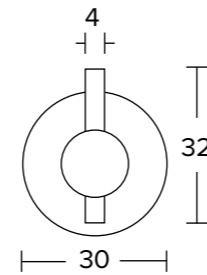
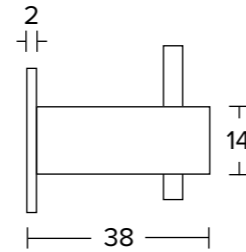

6552N Modric Bumper Hook

Description

- Projection 75mm x Ø19
- Supplied with concealed face fixings
- Hand finished
- Grade 316 solid stainless steel
- 25 year warranty

Available Finishes

SS · PS · BF

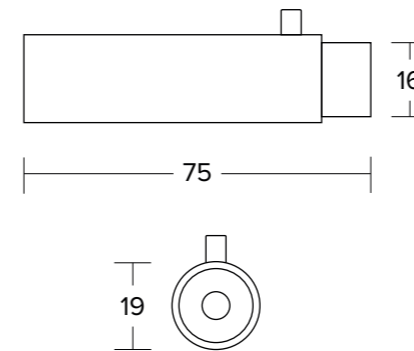

6540 Modric Coat Hook

Description

- Projection 23mm x Ø24/14mm
- Supplied with concealed face fixings
- Hand finished
- Grade 316 solid stainless steel
- 25 year warranty

Available Finishes

SS · PS · BF

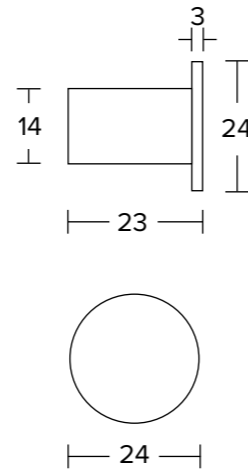

6854 Modric Grade 316 Kick Plates

Description

- Supplied with visible Torx screw fixings
- 1.5mm thickness
- All plates made to order
- Length and height dimensions to suit any application
- Incorporated in successful fire tests and assessed to BS EN 1634-1 and BS 476 Pt 22 for use up to 120 minute timber fire doors and up to 240 minutes for metal doors
- Grade 316 stainless steel
- 25 year warranty

Available Finishes

SS · PS · BF

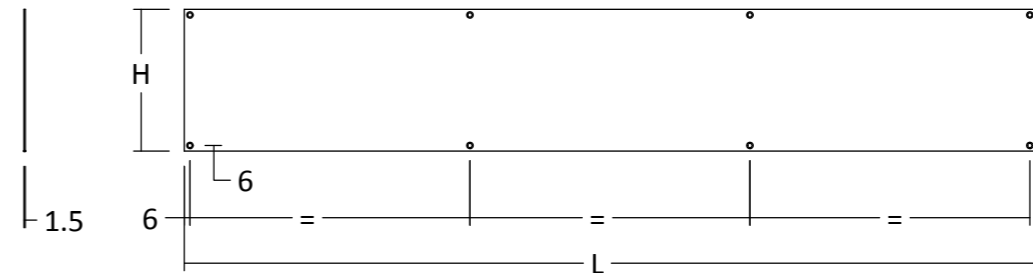

Modric Ø76mm signage

Description

- Ø76mm x 2mm thickness
- Supplied with Torx screw fixings
- Incorporated in successful fire tests and assessed to BS EN 1634-1 and BS 476 Pt 22 up to 120 minutes on timber doors and 240 minutes on metal fire doors
- Hand finished
- Grade 316 stainless steel
- Adheres to safety sign legislation BS 5499 (applicable to 8447, 8448, 8449 & 8450)

Available Finishes

SS · PS · BF

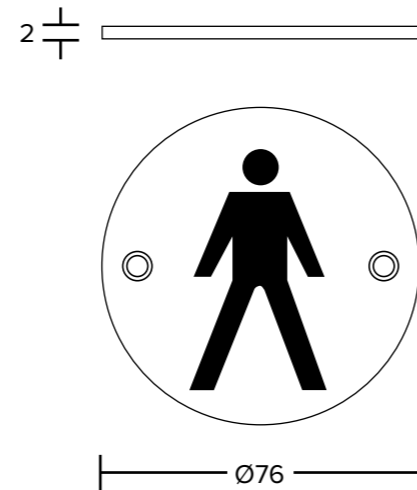

Signage options:

Item code	Sign	Adheres to safety sign legislation
8432	Male	
8433	Female	
8434	Unisex	
8435	Disabled	
8436	Ambulant	
8447	Automatic Fire Door Keep Clear (AFDKC)	BS 5499
8448	Fire Door Keep Locks (FDKL)	BS 5499
8449	Fire Door Keep Shut (FDKS)	BS 5499
8450	Fire Exit Keep Clear (FEKC)	BS 5499
8456	Shower	
8457	Baby Change	
8458	Cloakroom	
8459	First Aid	

Bespoke signs available

Modric Ø76mm self-adhesive signage

Description

- Ø76mm x 2mm thickness
- Supplied with Self-adhesive backing
- Incorporated in successful fire tests and assessed to BS EN 1634-1 and BS 476 Pt 22 up to 120 minutes on timber doors
- Hand finished
- Grade 316 stainless steel
- Adheres to safety sign legislation BS 5499 (applicable to 8547, 8548, 8549 & 8550)

Available Finishes

SS · PS · BF

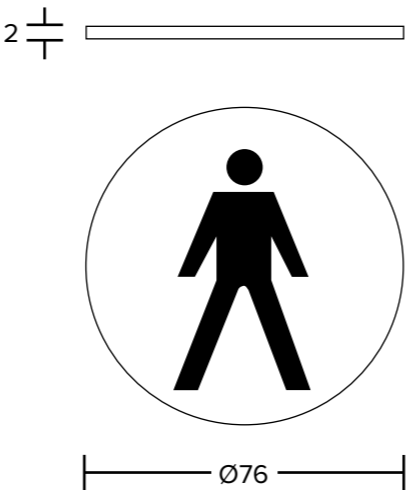

Signage options:

Item code	Sign	Adheres to safety sign legalisation
8532	Male	
8533	Female	
8534	Unisex	
8535	Disabled	
8536	Ambulant	
8547	Automatic Fire Door Keep Clear (AFDKC)	BS 5499
8548	Fire Door Keep Locks (FDKL)	BS 5499
8549	Fire Door Keep Shut (FDKS)	BS 5499
8550	Fire Exit Keep Clear (FEKC)	BS 5499
8556	Shower	
8557	Baby Change	
8558	Cloakroom	
8559	First Aid	

Bespoke signs available

Modric Ø50mm fire door signage

Description

- Ø50mm x 2mm thickness
- Supplied with Self-Adhesive backing
- Incorporated in successful fire tests and assessed to BS EN 1634-1 and BS 476 Pt 22 up to 120 minutes on timber doors
- Adheres to safety sign legislation BS 5499
- Hand finished
- Grade 316 stainless steel

Available Finishes

SS · PS · BF

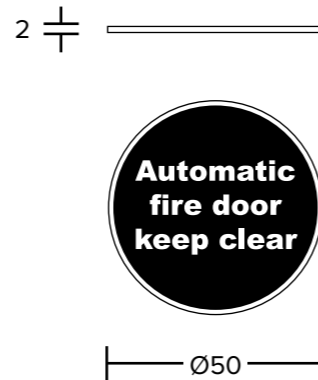

Signage options:

Item code	Sign
8447S	Automatic Fire Door Keep Clear (AFDKC)
8448S	Fire Door Keep Locks (FDKL)
8449S	Fire Door Keep Shut (FDKS)



Spectra

Modric is available in a kaleidoscope of decorative finishes from our Spectra range.

Whatever the palette and design theme of your project, our extensive selection of colours and finishes will offer many possibilities to stimulate your ideas.

Spectra Tech

Spectra Tech is our premium PVD vacuum coating process that results in a superior decorative finish in a range of metallic colours, in both matt and gloss. A hard-wearing solution, with excellent durability that will not fade and retains the touch and feel of steel. Incredibly thin – just 1/50th the width of a human hair – a product finished with our Spectra Tech process will not need lacquer and is tarnish and corrosion resistant, due to the resilience of the finish and the quality of the products as we only use the highest quality stainless steel.

BM • Matt black
BG • Gloss black
RM • Matt brass
RG • Gloss brass
ZM • Matt bronze
ZG • Gloss bronze
GM • Matt gold
GG • Gloss gold

Spectra Tone

Spectra Tone applies a simulated metal finish through an electrophoretic process for those projects where satin brass, gold, black or bronze is required. This coating can be lacquered and coloured with metallic dye solutions, including our distinctive BF bronze finish, to give colour, texture, and improved durability.

BF • Simulated bronze
BK(SKU)M • Simulated matt black
BK***G • Simulated gloss black
BA***M • Simulated matt brass
BA***G • Simulated gloss brass
BZ***M • Simulated matt bronze
BZ***G • Simulated gloss bronze
GL***M • Simulated matt gold
GL***G • Simulated gloss gold

Explore our complete Spectra collection at
allgood.co.uk/spectra



3509 in SS, BM & RM

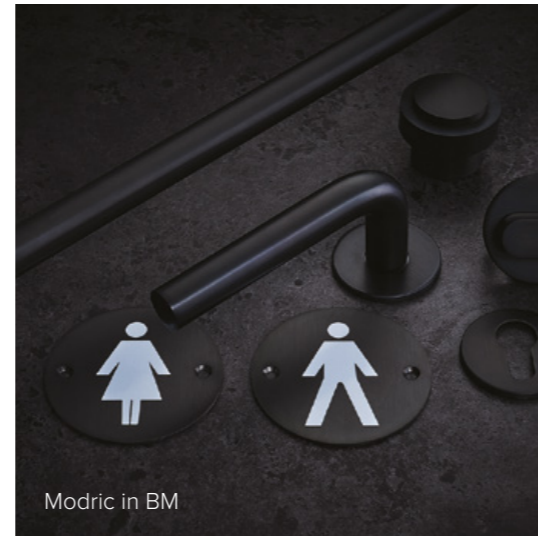

Modric in BM

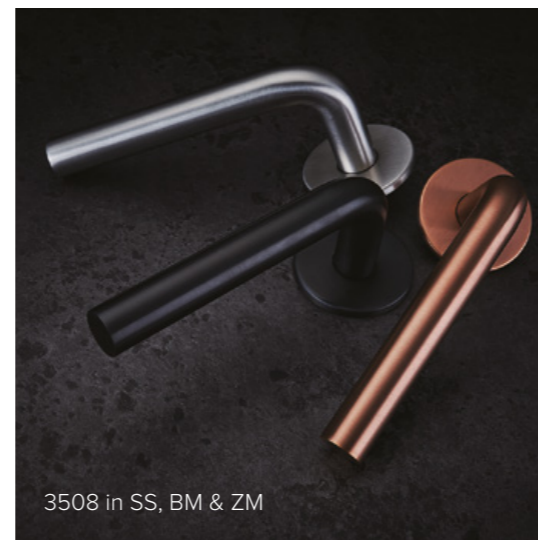

3508 in SS, BM & ZM

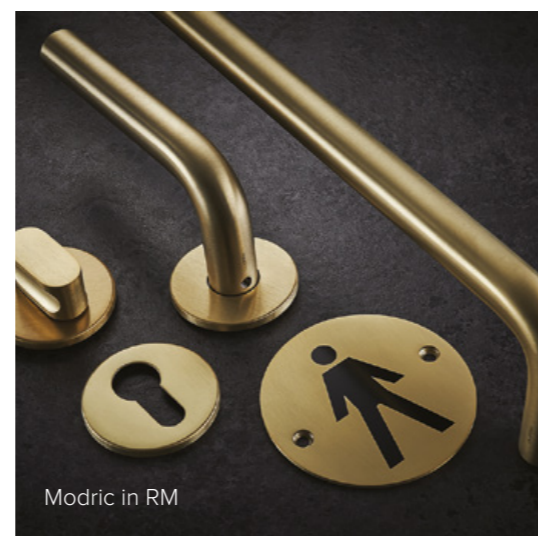

Modric in RM



Modric in BF



3510 in PS, SS, BF & RM

Client: 122 Leadenhall Street
Sector: Commercial
Location: London
Architect: Rogers Stirk Harbour & Partners
Products: Modric lever handles and co-ordinating door closers and hinges

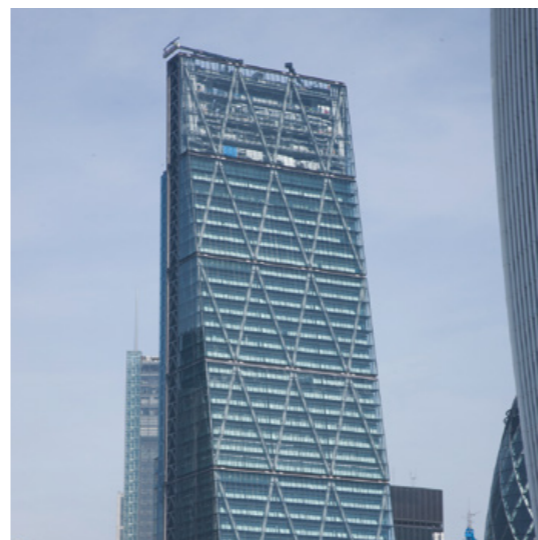

122 Leadenhall Street

Towering over London's skyline at 225 metres, 122 Leadenhall Street is the fourth tallest building in the UK. The skyscraper forms part of new generation of high-rise buildings in the City of London including the Gherkin, 20 Fenchurch Street, and the Lloyds Building.

Designed by Rogers Stirk Harbour and Partners and built by Laing O'Rourke, the distinctive slanted appearance of the building was prompted by a planning requirement to respect views of St Paul's Cathedral, in particular from Fleet Street. The solution was a slender, tapered structure that diminishes towards the apex. The building also has a striking external steel frame superstructure. More commonly used on infrastructure and offshore oil rigs, this tubular system replaced the need for the traditional concrete core to provide structural stability and is the largest and tallest ever used.

As the Leadenhall building is largely built for the commercial sector with a high-level of footfall, the ironmongery package had to suit the design and be highly durable. The Modric range was chosen for its elegant aesthetic and for its comprehensive 25-year mechanical warranty. The range exceeds the most stringent of European and British performance standards, made from premium solid grade 316 stainless steel and mounted on Allgood's patented Quadaxial™ rose that has been tested to over a million cycles without failure.

Like many modern buildings, there was a strong desire for its construction and use to be as sustainable as possible. Modric is made in the UK at Allgood's dedicated manufacturing plant in Birmingham from steel with up to 95% recycled content. It is also designed for a lifetime's use and will continue to perform for decades without need for repair or replacement.

Crossrail Place, Canary Wharf

Crossrail Place in Canary Wharf, London, is a landmark development within the Crossrail Project, the biggest railway infrastructure project in Europe. Designed by Foster & Partners and constructed by Canary Wharf Contractors, the £500 million project is located in the north dock, between the HSBC tower at Canary Wharf and the residential neighbourhood of Poplar.

The mixed-use scheme combines five floors of retail and hospitality, as well as new public parks and performance spaces, all built above the new Crossrail station. The whole complex is surrounded by water and the station itself sits 28 metres below the surface. Central to the development is a striking 300-metre timber lattice roof that houses an enclosed tropical rooftop garden.

Canary Wharf's Crossrail station opened in 2018 as one of seven new underground stations built to accommodate the Crossrail project. With a 256-metre-long station box, it is also one of the largest stations on the Crossrail network. When Crossrail is fully operational, the station will handle 68,000 daily passengers travelling on 12 trains an hour, as well as acting as a vital interchange for the Jubilee Line and DLR.

The ironmongery package needed to withstand the building's high footfall, as well as suit the design theme. With its comprehensive 25-year warranty and uniform aesthetic, the Modric range was chosen to provide an elegant yet robust solution. Made from solid grade 316 stainless steel and with all levers mounted on Allgood's patented and maintenance-free Quadaxial™ rose Modric exceeds the strictest performance standards.

Security was also of paramount importance to the project. Allgood Secure installed high-security solenoid Redlocks™ throughout the project as part of a comprehensive access control solution, giving the building managers the safety and flexibility needed to manage access.



Client: Crossrail Place, Canary Wharf
Sector: Public Sector
Location: Canary Wharf, London
Architect: Foster & Partners
Products: Modric lever handles, Modric pull handles & solenoid Redlocks





Client: Glasgow School of Art
Sector: Education
Location: Glasgow
Architect: JM Architects
Products: Mix of Modric and bespoke including Modric lever handles, Modric pull handles, push plates and Allgood floor springs

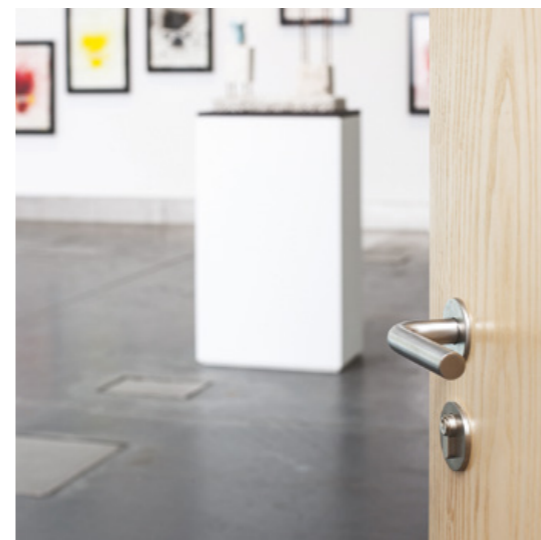

Glasgow School of Art

The Glasgow School of Art (GSA) was formed in 1845 and is internationally recognised as one of Europe's leading university-level institutions for the visual creative disciplines. Famous for its Charles Rennie Mackintosh designed art school, a new £50m development by Steven Holl and JM Architects sees the addition of the Reid building and the refurbishment of GSA's student union, the Assembly building, also known as the 'Vic'.

The Reid building - named after Dame Seona Reid, the former director of the GSA – is the new home of the university's design school. In contrast to the surrounding 19th-century buildings, the new campus follows a more contemporary design. It features an external skin of semi-transparent acid-etched glass panels and employs state-of-the-art digital and concrete technology to achieve its arcs and sweeping curves. Three 'driven voids of light' cut through the structure, acting as large light shafts, and helping with natural air circulation

The refurbishment of the Vic updated the interior and facilities of this Art Deco building. A live music venue and student union the Assembly is renowned as a launchpad for famous bands including The Clash and Franz Ferdinand.

JM Architects required an ironmongery specification that would stand up to high levels of use, as well as match the design intent. Allgood provided a suite of ironmongery that included the Modric range, with its clean lines and robust construction proven to perform for decades. Modric lever handles and Allgood floor springs were used on the large gallery swing doors, which were 3m tall x 2m wide.

The ironmongery package also included push plates and pull handles for the irregular shaped double doors in the lecture rooms, and a bespoke sliding door system was fitted on an entrance to the gift shop.

Manchester Cancer Research Centre

Designed by Wilson Mason Architects, the Manchester Cancer Research Centre (MCRC) is a state-of-the-art research facility and home to 150 researchers.

The public-facing facility has been designed with an integrated environmental approach, featuring 85% natural ventilation and rainwater harvesting – earning the project an ‘excellent’ BREEAM rating.

Allgood was asked to supply an ironmongery package that reflected this sustainable approach, while catering for the building’s high-performance requirements.

The MCRC is a partnership between The Christie Hospital, Cancer Research UK and the University of Manchester, meaning the building experiences a high footfall. For this reason, a Modric suite of ironmongery was specified in a coordinated stainless-steel finish, complementing the clean aesthetic of the building’s interior. In addition, Modric lever and pull handles were fitted on the internal doors, providing a durable and high-quality product that provides a 25-year warranty.

All of the stainless-steel door fittings supplied are manufactured from up to 95% reclaimed content and fully recyclable at the end of the products’ life. Manufactured in our factory in Birmingham, the Modric ironmongery supplied demonstrated lower carbon emissions through a shorter supply chain, contributing to the ‘Excellent’ BREEAM rating of the building.







Available from :

modric Inc.

National Headquarters North America
Boulder
Colorado CO 80302"

E: support@modric.net